

# DANA-FARBER Main Campus

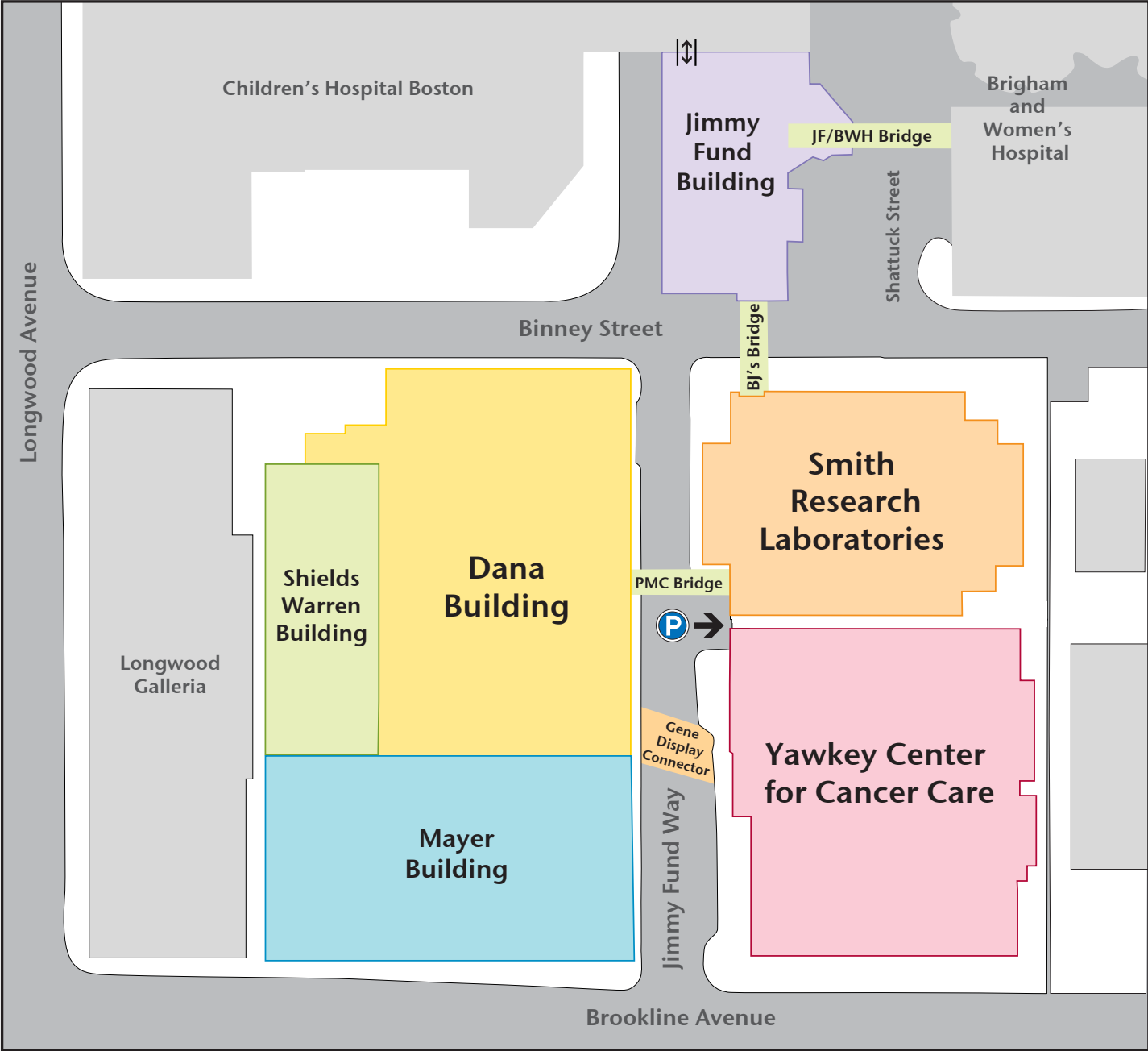

# YAWKEY Floor P1

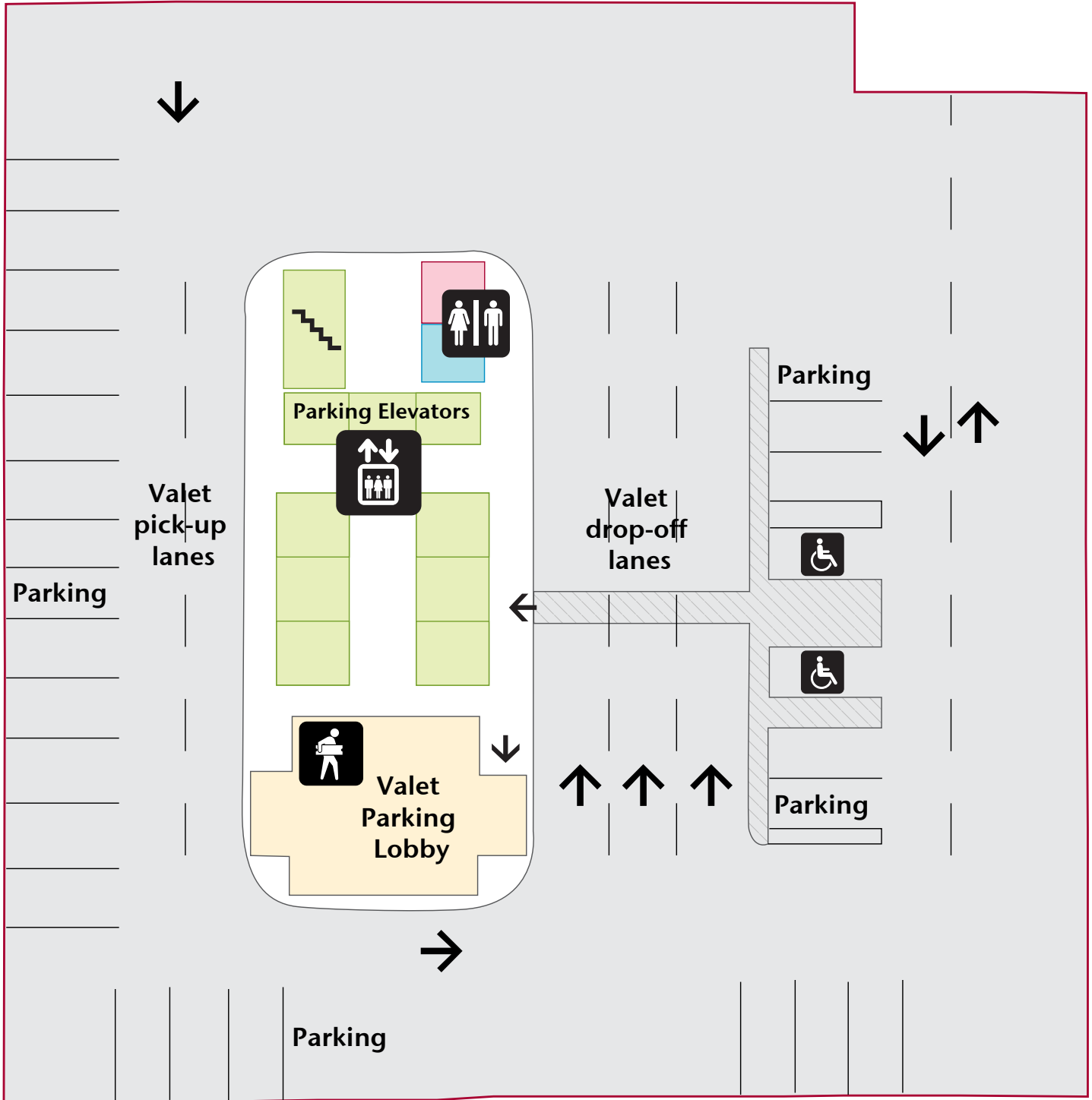

**Parking Pay Station**

# YAWKEY Floor 1

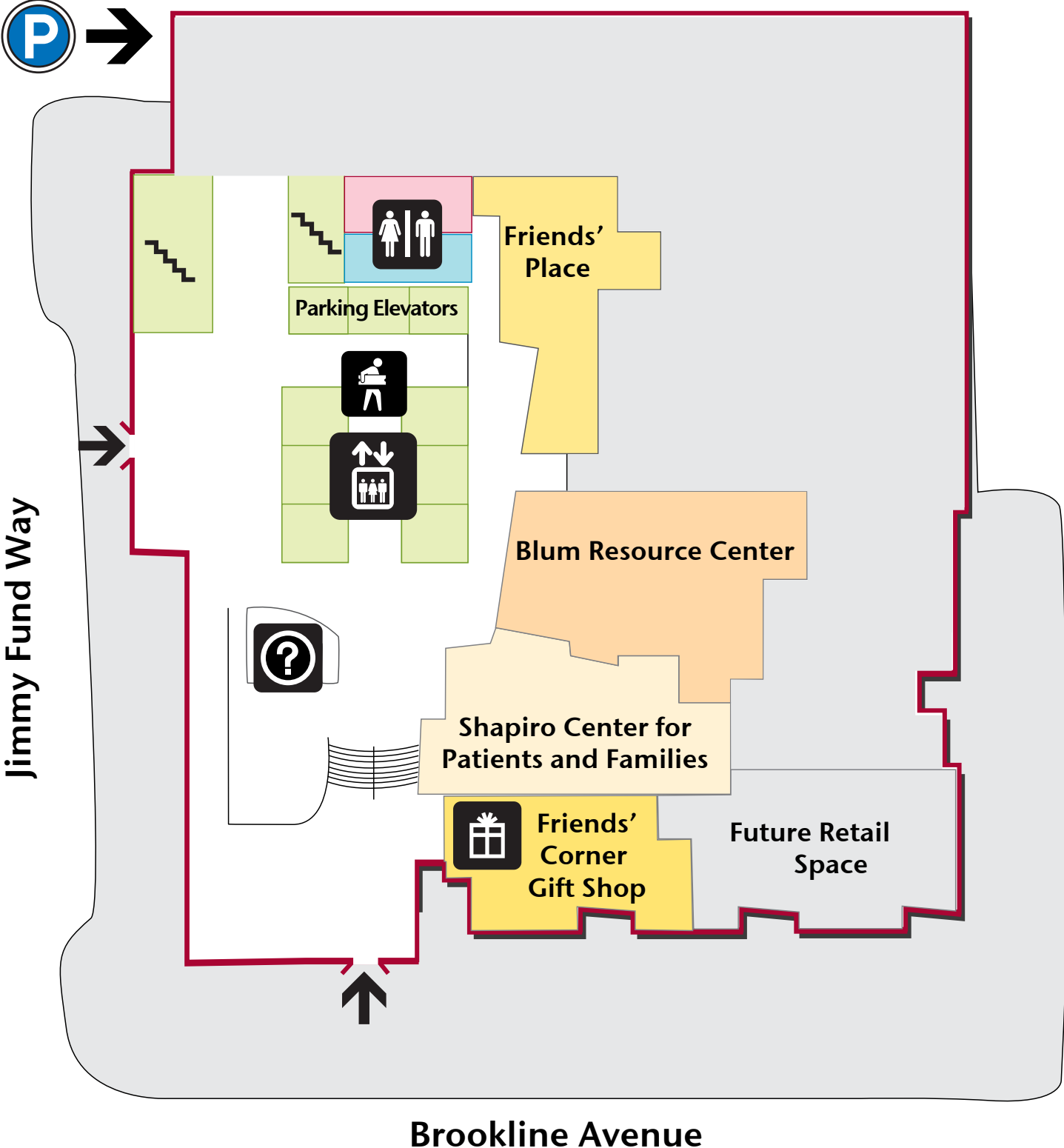

# YAWKEY Floor 2

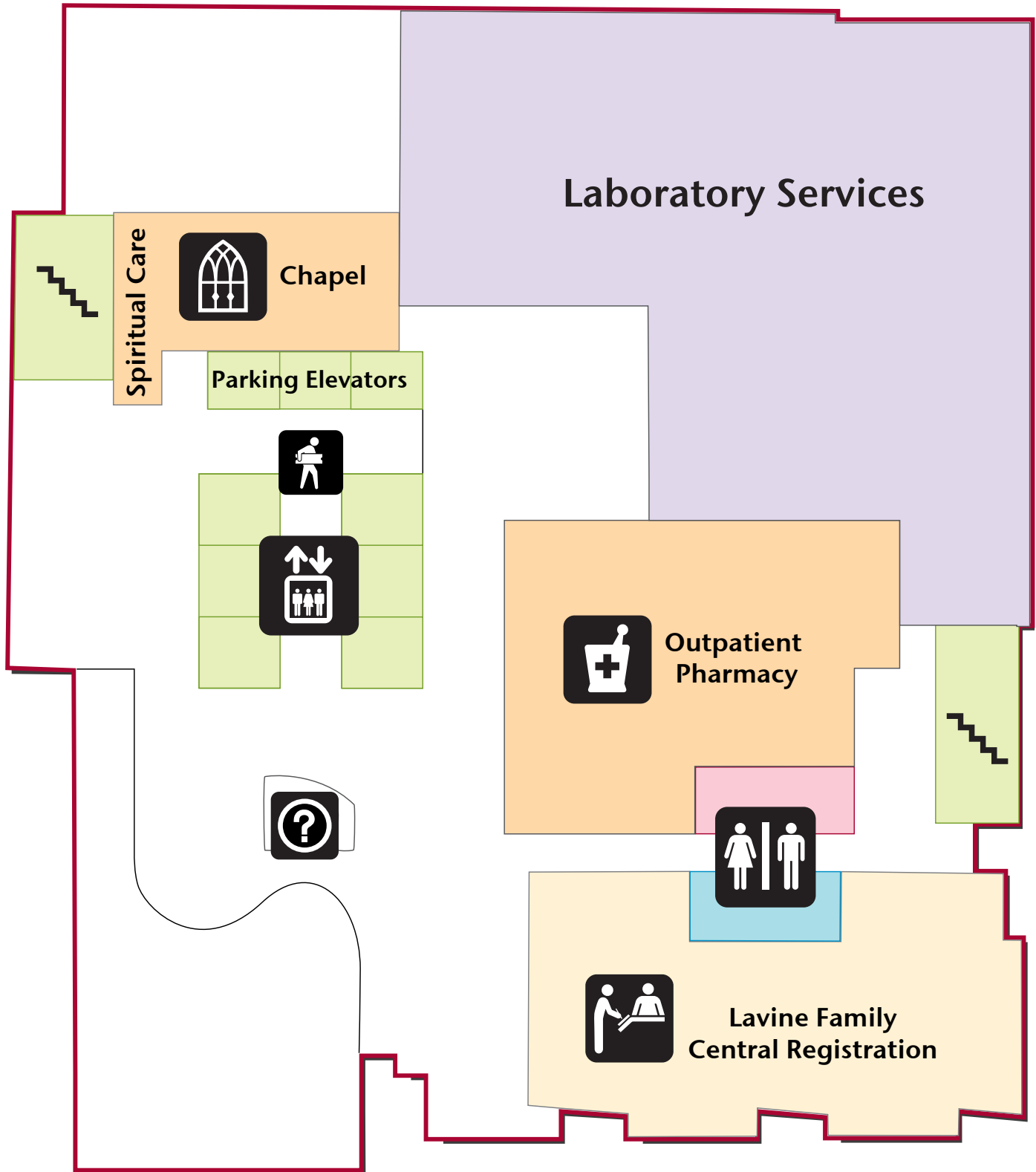

# YAWKEY Floor 3

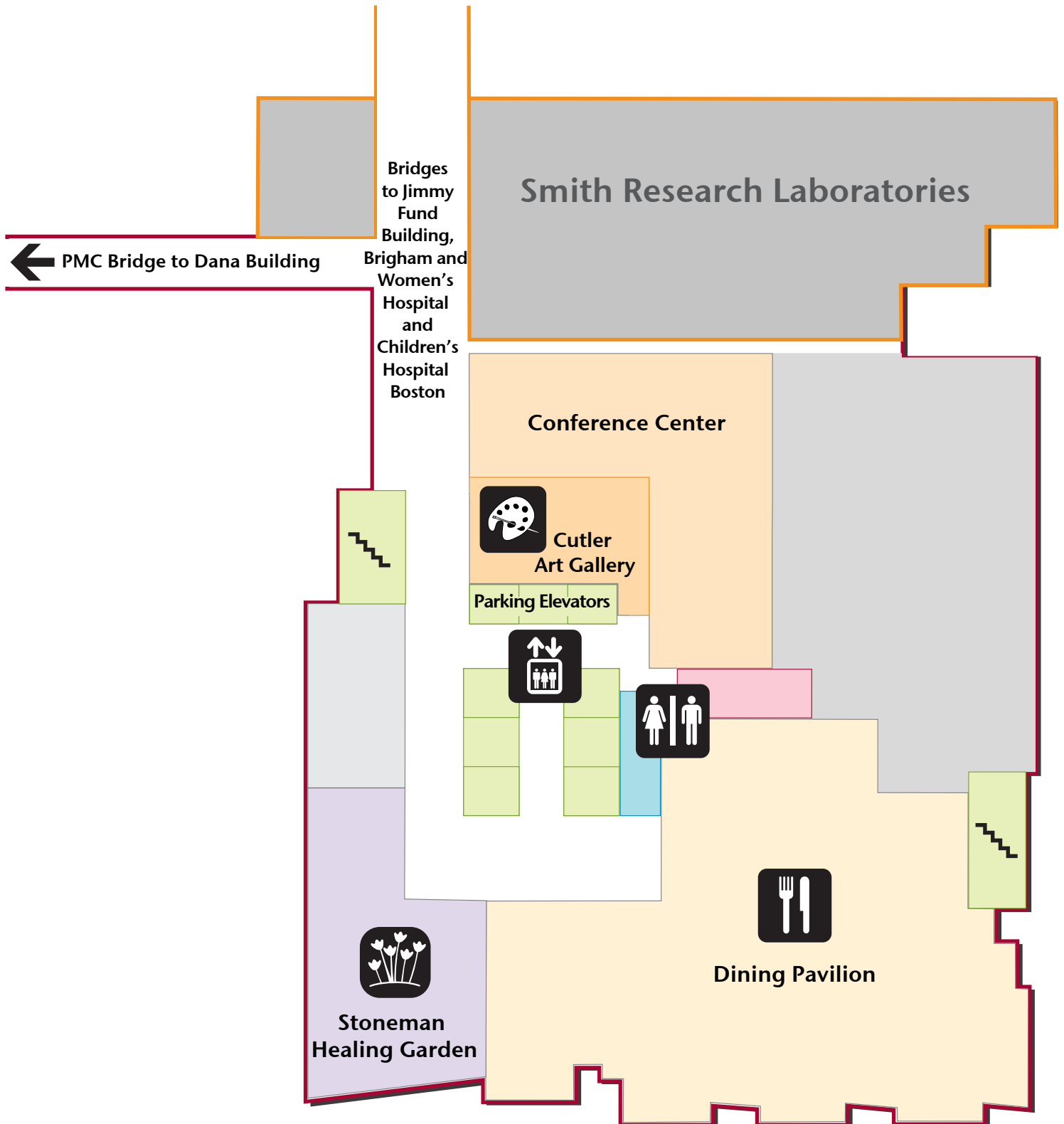

# YAWKEY Standard Clinical Floor Floors 6-11

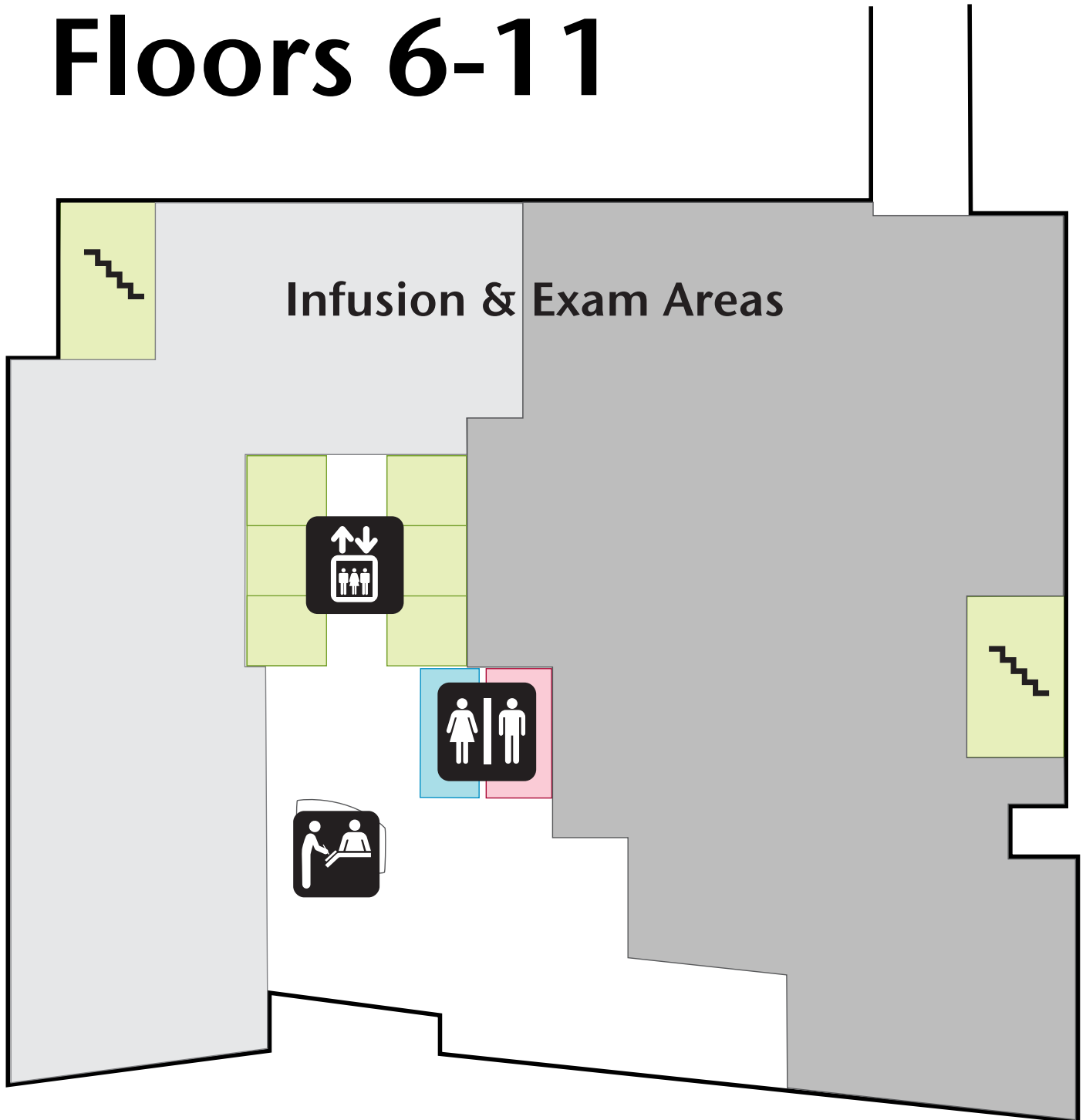

# Dana-Farber Cancer Institute Longwood Campus

All locations are in the Yawkey Center unless otherwise noted.

Cutler Art Gallery	3	Interpreter Services	Shields Warren 1
<i>Jimmy Fund</i> Auditorium	Jimmy Fund G	<i>Jimmy Fund</i> Clinic	Dana 3
<i>Kraft Family</i> Blood Donor Center	Jimmy Fund 1	<b>Laboratory Services</b>	2
Breast Oncology	9	Leukemia	8
<b>Bridges to affiliated hospitals</b>	3	<i>Bekenstein Family</i> Atrium Lobby	1
Brigham and Women's Hospital		<i>Lubin</i> Lobby	2
Children's Hospital Boston		Lymphoma	8
Brigham and Women's Hospital	via 3rd floor bridge	Medical Records	Dana 1A
<i>Friends of Dana-Farber</i>	11	Melanoma	11
Cancer Genetics and Prevention		<i>Lipper</i> Center for Multiple Myeloma	7
Chapel	2	Neuro-Oncology	8
Children's Hospital Boston	via 3rd floor bridge	Nuclear Medicine	Dana L2
Clinical Research Center	6	Occupational Health Services	Dana 1A
Concierge Services ( <i>Shapiro</i> Center)	1	Adult Palliative Care	11
Conference Center	3	Parking Elevators	P2-3
Cutaneous Oncology	11	Parking Valet/Cashier	P1
Dana Building and		Patient and Family Drop-off/Pick-up	P1
<b>Gene Display Connector to:</b>	P2	<i>Blum</i> Patient and Family Resource Center	1
<i>Lank</i> Imaging		<i>Blum</i> Pediatric Resource Room	Dana 3
Nuclear Medicine		Pharmacy Administration	5
Radiation Oncology		Outpatient Pharmacy	2
<b>PMC Bridge to:</b>	3	Procedure Suite	6
<i>Jimmy Fund</i> Clinic		Radiation Oncology	Dana L2
<i>Stop &amp; Shop Family</i> Pediatric Brain Tumor Clinic		<b>Registration</b>	
Pediatric Psychosocial Oncology		<i>Lavine Family</i> Central Registration	2
<i>David B. Perini, Jr.</i> Quality of Life Clinic		Imaging and Radiation Oncology Registration	Dana L2
Desensitization Unit	6	Pediatric Registration	Dana 3
Dining Pavilion	3	Sarcoma and Bone Oncology	9
Early Drug Development	6	<i>Shapiro</i> Center for Patients and Families	1
<i>Friends'</i> Corner Gift Shop	1	Specialty Clinics	Dana 1A
<i>Friends'</i> Place	1	Spiritual Care	2
Gastrointestinal Oncology	7	Stem Cell Transplantation	8
<i>Lank</i> Center for Genitourinary Oncology	11	<i>Perini Family</i> Survivors' Center	Shields Warren 1
Gynecologic Oncology	10	<i>Lance Armstrong Foundation</i>	Dana 1A
Head and Neck Oncology	11	Adult Survivorship Clinic	
<i>Stoneman</i> Healing Garden	3	<i>Lowe</i> Center for Thoracic Oncology	10
Hematologic Malignancies	7, 8	<i>Susan F. Smith</i> Center for Women's Cancers	9, 10
Hematology	7	Breast Oncology	9
<i>Lank</i> Imaging	Dana L1	Gynecologic Oncology	10
Information	1, 2		
<i>Zakim</i> Center for Integrative Therapies	Dana 1A		

# Patient & Family Resources

*All locations are in the Yawkey Center unless otherwise noted.*

<i>Cutler</i> Art Gallery	3
Chapel	2
Concierge Services ( <i>Shapiro</i> Center)	1
Dining Pavilion	3
<i>Friends'</i> Corner Gift Shop	1
<i>Friends'</i> Place	1
<i>Stoneman</i> Healing Garden	3
Interpreter Services	Shields Warren 1
Outpatient Pharmacy	2
<i>Blum</i> Patient and Family Resource Center	1
<i>Shapiro</i> Center for Patients and Families	1
<i>Blum</i> Pediatric Resource Room	Dana 3
Spiritual Care	2
<i>Perini Family</i> Survivors' Center	Shields Warren 1